



March 11, 2017

On behalf of the Plainfield High School Band and Guard, I would like to welcome you to Regional A Semi-Finals and Divisional Finals for Divisional Regional A. Our band program takes great pride in hosting every event. We have worked many hours in preparation for this day. It is our hope that participant and spectator alike will find that our community, school, parents, and students are here to make your experience enjoyable.

To each competing guard, we wish you the best of luck today and throughout the remainder of your marching season. We understand the hard work and effort on the part of all the directors, students, and parents.

We hope you will enjoy today's competition and find great success in each guard's accomplishments. We are honored to host you today and are looking forward to having you back next year.

Sincerely,

Michael Carpenter

Michael Carpenter
Director of Bands
Fine Arts Department Chair

IHSCGA Regional A Semi-Finals & Divisional Finals for Divisional Regional A

Plainfield High School
Saturday March 11, 2017

Food or drink may NOT be brought into the building. Coolers are NOT allowed.

GUARD CHECK-IN:

Enter through the North Entrance at **Door 21**. Doors will be open at 8:30am. All participants, prop helpers, and staff should check in together. Please remember that you are allowed the # of performing members per your declaration sheet and up to eight (8) tickets for additional helpers (student or adult) Any person admitted free of charge will be issued performer wristbands for backside seating only. Additional student helpers may purchase back side seating for \$3.00 at check-in when they travel with your group.

A maximum of two (2) wristbands will be issued for your drivers. All others must be paid for at this time. The IHSCGA has set the front side ticket cost for this event at \$8.00 for an Adult, \$6.00 for Student/Senior Citizens (over the age of 65) Children age 5 and under are \$3.00 and infants not needing a seat are free. Wristbands are good for both contest sites (Plainfield & Center Grove)

BUS PARKING:

Busses will park on the NORTH side of the school.

There will be no bus parking in the front lot until all groups in all classes have arrived and unloaded.

DIRECTOR PARKING:

Staff vehicles will also be parking on the EAST side of the school near the main entrance (door 1).

GENERAL SPECTATOR ADMISSION:

All spectators will park in the South parking lot near the bell tower/stadium. Doors will open at 10:00AM. All spectators will enter the building through the doors located on the SOUTH side of the building at Door 7 near the bell tower. The IHSCGA has set the front side ticket cost for this event at \$8.00 for an Adult, \$6.00 for Student/Senior Citizens (over the age of 65) Children age 5 and under are \$3.00 and infants not needing a seat are free. Wristbands will be used. No admission to the gym without a wristband. Tickets will also be on sale at guard check in.

HOMEROOMS:

You will be assigned a 20'X5' section of a hallway that will be taped off for you to use to store your guard's items. We will have volunteers assigned to each area to make sure things are safe. Dressing rooms can be found on the map. Please check the schedule for when you are to be out of our home room area.

GYM, TIMELINE, WARM-UP, ETC:

Please see appropriate map. If you have any questions or need assistance please do not hesitate to ask any of our workers.

HOSPITALITY ROOM:

This will be located in the lobby of our auditorium located just inside door 1. This will be hospitality for directors and staff only. Please have your badges when you enter. Driver hospitality will be in the teacher's lounge.

PROPS:

Props will enter the building through Door 21. This is the same door as check-in. This entrance will have 3 sets of double doors with the posts removed for larger props. No one will be allowed to enter the building without a wristband, so please communicate this with your volunteers. The prop loading area will begin in the large hallway that goes throughout the length of the school into a small section of the cafeteria. Please plan to load your equipment immediately following your performance. All props must pass inspection in compliance with IHSCGA rules. Props that are not in compliance will not be permitted in the gym until they pass inspection. Please make sure your props and equipment have rubber tips and padding. If something doesn't pass inspection, we will try to tape what we can. If we cannot ensure that our gym will not be damaged from props or equipment, it will not be allowed in the gym.

VIDEOS: Will be available via <http://ihscga.video>. You have been provided your username and password earlier in the season. There is no charge for this as it was included in your contest fee for this event. Parents are allowed to videotape, but are permitted to record only their own group.

RECAPS/SHEETS/PACKETS:

These may be picked up in the hospitality room shortly after the conclusion of both Semi-Finals rounds. Divisional Regional A Class packets may be picked up at the announcers table following the awards ceremony.

PHOTOGRAPHER:

Bateman Photographic Services will offer group and action photos. Group photos will be post performance.

AWARDS:

The top 12 scoring units in Regional A, regardless of round, will advance to State Finals to be held at Center Grove High School on March 18th, 2017. Scores will be posted on the windows of the Ellipse located near the cafeteria after each round. Groups not advancing to finals will receive 2017 Semi-Finalist chevrons for each of their members. These will be in your packet along with recaps.

Groups in Divisional Regional A will have a full retreat ceremony at the conclusion of the contest. Please assemble your groups in the warm-up gym immediately following the last Divisional Regional A performance.

CONCESSIONS:

Concessions will be sold from 9:00am until 6:45pm. We hope your students and parents will take advantage of this. Per IHSCGA policy, outside food or drinks are NOT to be brought into the building.

CRITIQUE:

Only guards advancing to finals will be able to attend critique. This will begin after the last guard has performed in Divisional Regional A. It will be held in the auditorium lobby.

EMERGENCY PHONE NUMBERS: Please contact Mike Carpenter at 317.439.1286 or Dana Commander at 317.445.9355. Cell reception is not great in the building, so please leave a message or text.

Contest Site: Plainfield High School 1 Red Pride Drive Plainfield, IN 46168

Emergency Contact Numbers:

Michael Carpenter 317.439.1286 Call or Text

Dana Commander 317.445.9355 Call or Text

PHS Band Office 317.839.2578 ext. 1117

- **From North** take I-465 West to I-70 West. Take exit 66 to IN-267 North. Turn left at the second stop light onto Reeves Road.
- **From South** take I-465 West to I-70 West. Take exit 66 to IN-267 North. Turn left at the second stop light onto Reeves Road
- **From East** take I-70 West. Take exit 66 to IN-267 North. Turn left at the second stop light onto Reeves Road
- **From West** take I-70 East. Take exit 66 to IN-267 North. Turn left at the second stop light onto Reeves Road





Spectator
Parking

Spectator Entrance
Door 7

**2017 IHSCGA Regional A
Semi-Finals
& Divisional Finals for
Divisional Regional A**

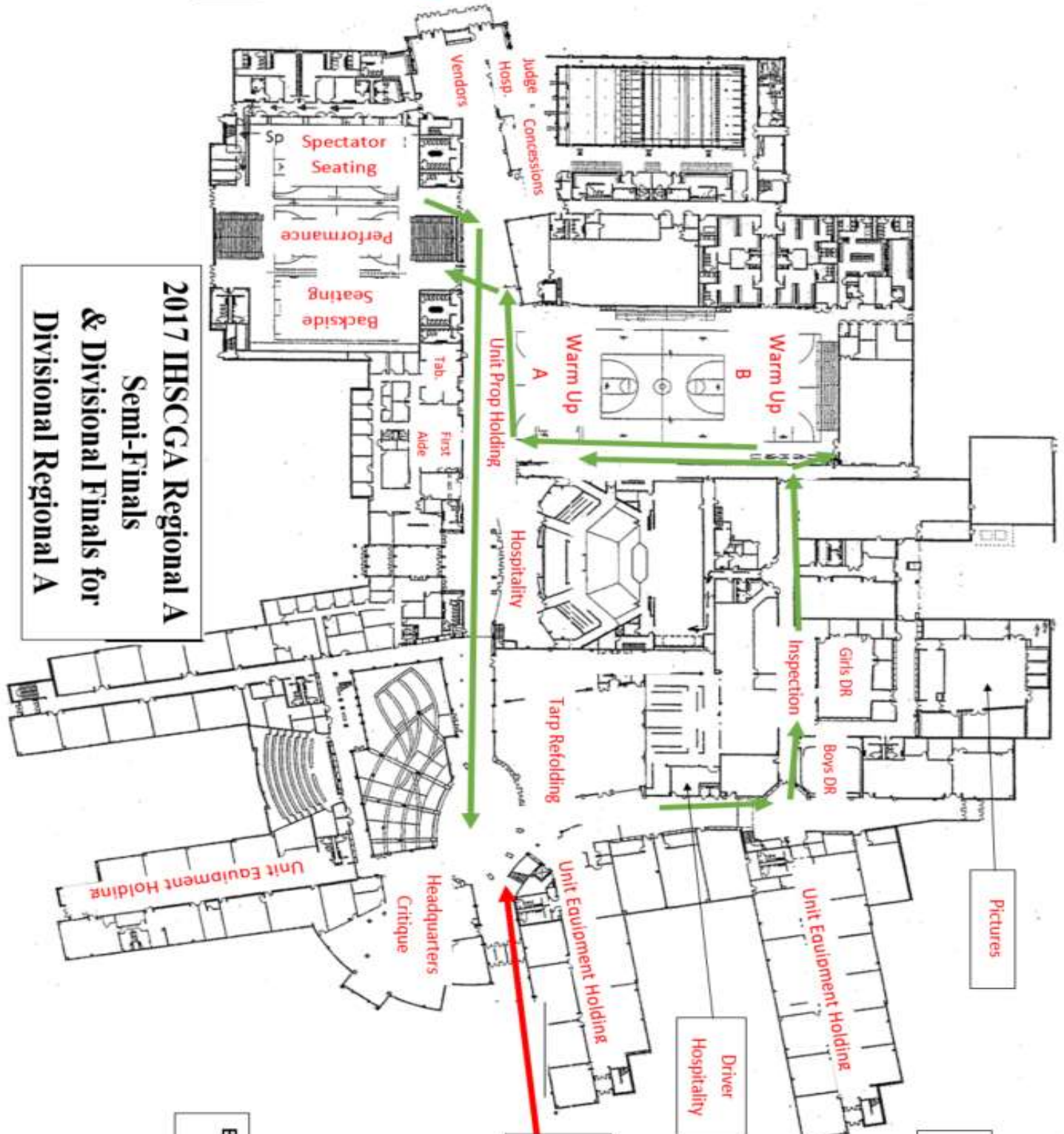

Performance Gym Layout

Backside
Seating

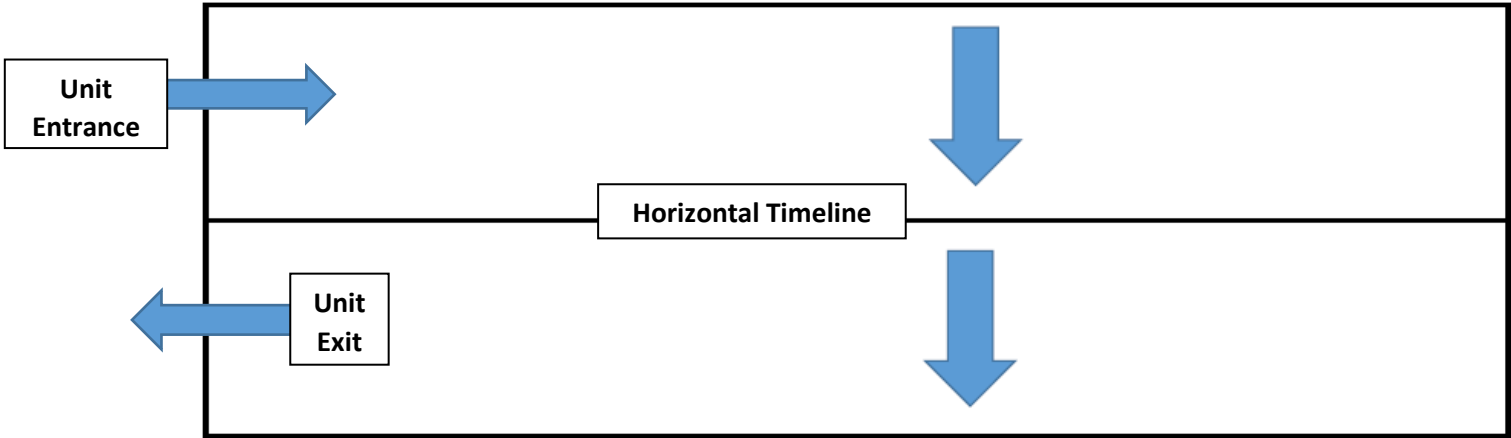

Spectators

