

# IHSCGA Color Guard Contest at East Noble High School

901 Garden Street, Kendallville, IN, 46755

February 3<sup>rd</sup>, 2018

**No outside food or drink may be brought into the building.**

**Guard Check In** – Is located at Door 36 off of Garden Street. **Please approach via Henry Street** This street will be blocked off to normal traffic and will be in close proximity to where your buses will park. Make sure the director of your unit is present to identify the free admissions and check in. Extra student prop tickets are \$3. Extra adult prop tickets are \$7

**Bus Parking** – Buses should approach ENHS via Henry Street. Buses will remain on garden street for the duration of the performance. Overflow bus parking will be on the south end of the school near door 30. About a 50 yard walk from your drop off location.

**Director Parking** – Due to limited space no special director parking is available at this time. Should this change we will let you know the day of the contest upon check in.

## **General Spectator Admission**

All spectators should approach East Noble High School via Lisle Street. Upon entering the main parking lot they will enter door 3 labeled “Cole Auditorium”. There will be a large electronic sign helping your friends and family locate this door. Parking volunteers will be on hand to help guide spectators into the parking lots. Wristbands will be used. No admission to the gym without a wristband. Wristbands will also be on sale at guard check in.

**Homerooms** – Homeroom areas will be in the 600 and 500 hallways. It is strongly discouraged to leave valuables in the homeroom area. Neither ENHS or IHSCGA are responsible for lost, stolen, or damaged items. You may not check into your homeroom area until 1 ½ hours prior to the beginning of your rotation time. We ask that you vacate your homeroom area no later than 1 hour past your performance time. Dressing Rooms are located in rooms 619,615, and 612.

## **Gym, Timeline, Warm-up, Etc.**

Please see the maps attached for routing procedures. If you have any questions or need assistance, please do not hesitate to ask any of our volunteers. We are happy to offer you our cafeteria as a stretching area. You may use music, but please be mindful that this space is open for any group and keep any volumes to a minimum.

Inspection and warm up will be located in the auxiliary gymnasium. This is a large space. Inspection will take place in the hallway entering the gymnasium and each warm up will consist of more than a full basketball court in size.

## **Critique**

Critique will be held in the Director's Hospitality room.

## **Hospitality Rooms**

Director Hospitality is located in the large band room (852) across from the main performance gymnasium. Private restrooms are available. **Directors and instructors only with IHSCGA badges please** so you have a place of respite. Driver hospitality is located in the small band room (856).

## **Props**

Equipment should proceed directly to door number 8 and bypass color guard check in. This street can be accessed by our main parking lot or by Sherman Street. Door 8 is easily located as the football stadium is nearby. Props will unload and hold in the choir room. Props will load out door 11 which will lead to the same parking lot your trailer is stationed to unload.

## **First Aid**

First Aid will be available in the trainer's room located in the hallway between the warm up gym and performance gym. If you have someone that needs first aid please contact an East Noble volunteer to assist you getting to the first aid area.

## **Videos**

A video of your group's performance will be available via Competition Suite

## **Recaps, Sheets, packets**

Can be found in hospitality shortly after your performance.



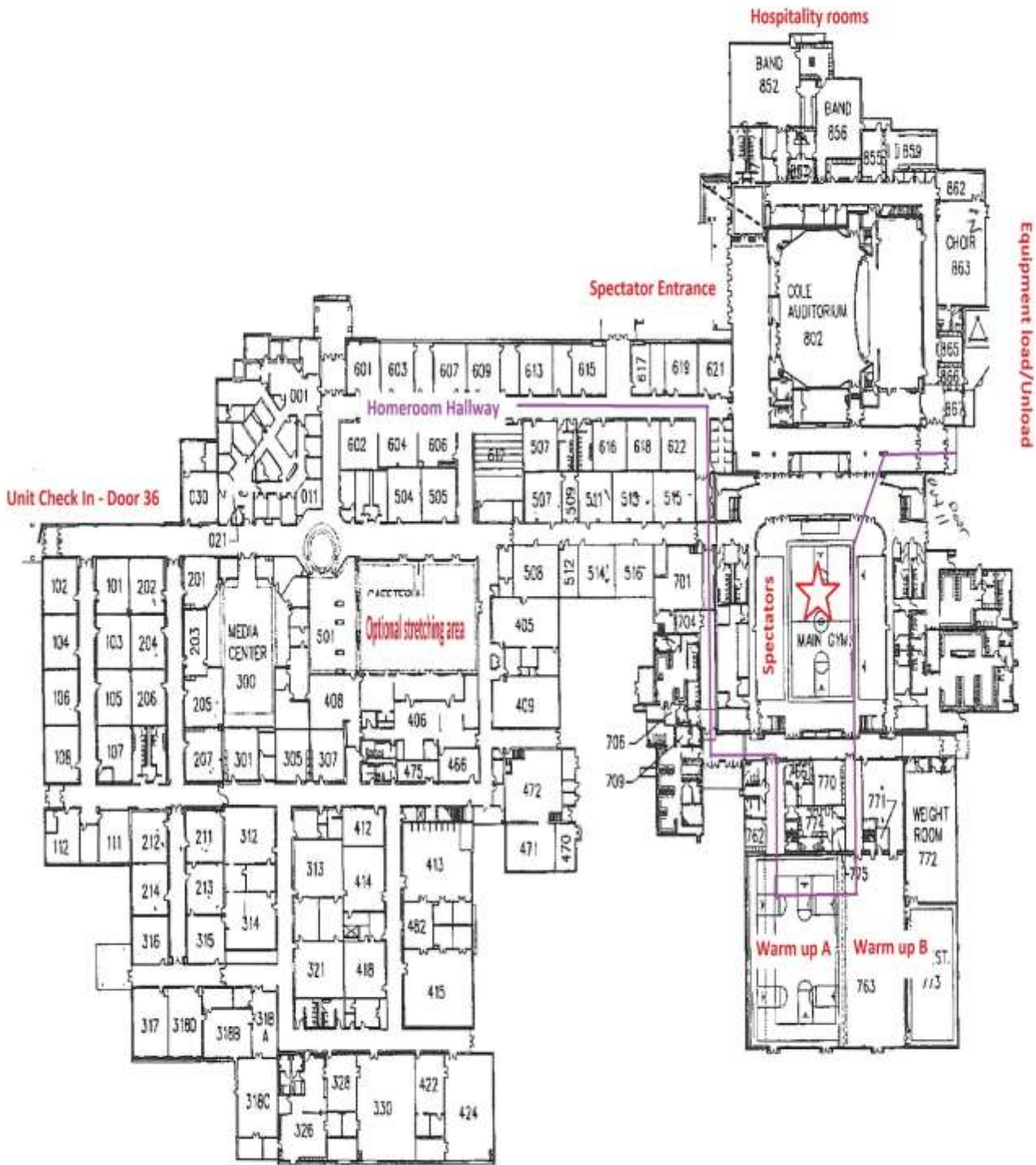

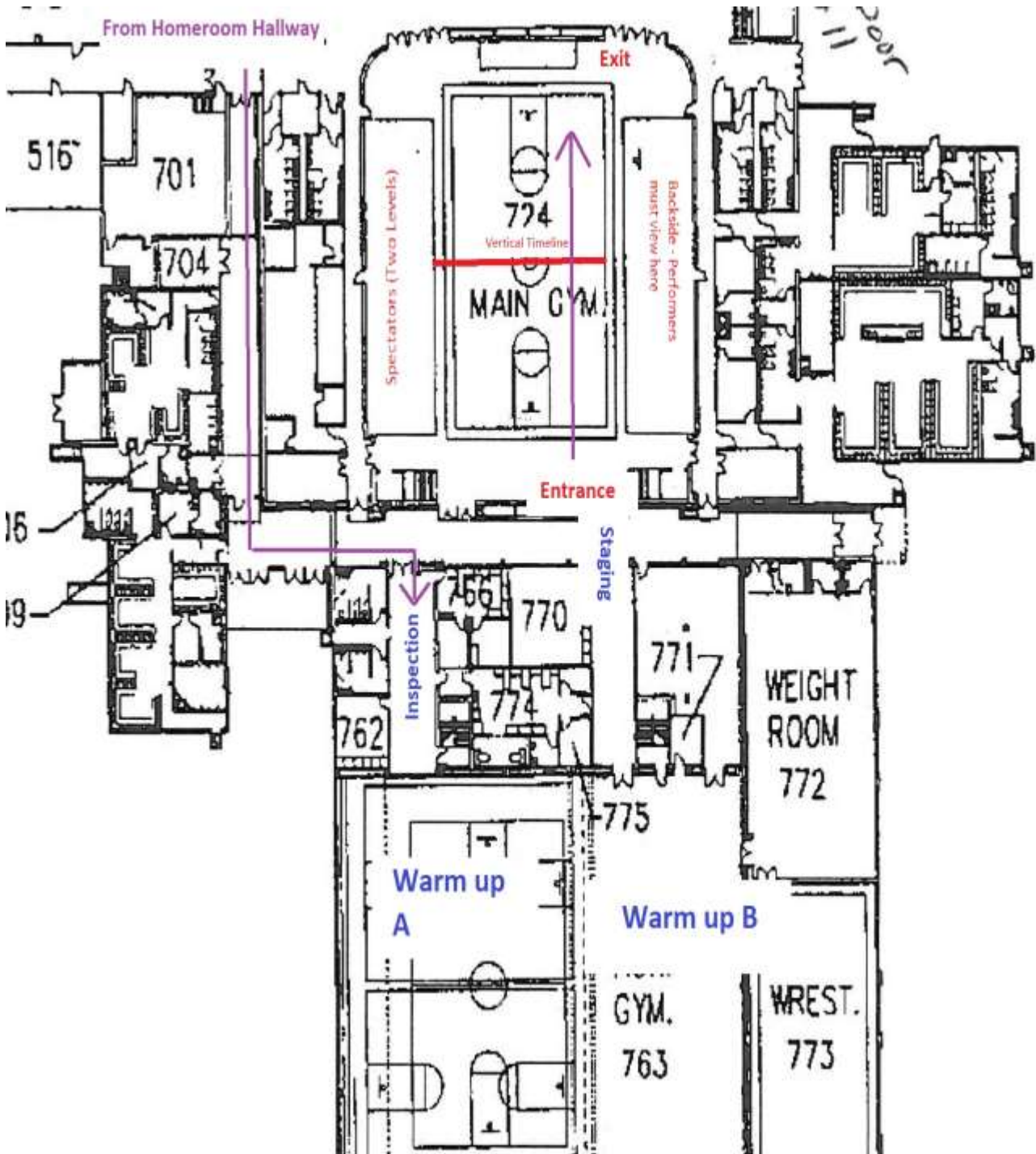

BACKSIDE

GUARD EXIT

GUARD ENTER

VERTICAL TIMELINE

Spectators/Judges

