

# Shamrock Winter Showcase

February 2<sup>nd</sup>, 2019

Westfield High School

IMPORTANT - SHARE WITH YOUR PARENTS, FANS, DRIVERS:

OUR MAPQUEST / GPS ADDRESS IS

18250 North Union Street, Westfield IN 46074

**No food or drink may be brought into the building. No coolers will be allowed.**

**\*Please note that WHS is under construction this year and some areas will be off limits. Also, please note a change in our parking and entrance areas for this year.**

## **GUARD CHECK IN**

All Buses will enter the Westfield High School campus via the East Entrance off of North Union Street. Check IN will be located at the Southeast doors, **Door 5**, (Auditorium Entrance) off of Union Street. Make sure the director of your unit is present to identify the free admissions and check in. Extra student prop tickets are \$3. Extra Adult prop tickets are \$7.

## **BUS PARKING**

Buses will exit the Check IN Area and turn left down Hoover Street then left down Union Street to park in the North Lot of the building outside of Door 23. Drivers will receive their wristband once they have parked from a parking official. **Only one (1) wrist band per bus/equipment vehicle will be distributed.** **Due to construction Buses will only be allowed to park in this lot or across Hoover Street at Westfield MS.**

For pick up at the conclusion of the contest once your group is ready to leave buses may line up along the sidewalk outside door 4 all the way to door 6. Please inform your drivers to not park outside doors 7&8 as those are for spectators. All equipment vehicles need to stay parked in the North Lot outside door 23 during the contest.

## **Director Parking**

In the lot just outside of the Check IN Area. **See map.**

## **GENERAL SPECTATOR ADMISSION**

All Spectators will enter the Westfield High School campus via the East Entrance off of North Union Street Door 7 (Cafeteria Entrance). Parking Volunteers will be on hand to help guide spectators into the parking lots. Wristbands will be used. No admission to the gym without a wristband. Wristbands will also be on sale at guard check in.

## **HOMEROOMS**

Homeroom areas will be in hallways or the Auditorium. Please do not leave valuables in the homerooms area. Dressing Rooms are located in our LGI room located near the guard check in area and designated restrooms. Units should not use the concession area restrooms as changing areas. For Security purposes please note that only individuals with Director, Performer or prop passes will be allowed into the Homeroom areas. If you have someone arriving late please meet them to get their pass at the Guard Check IN table or Spectator Entrance. Spectators wishing to meet up with their student or director will need to meet in the concessions area. If it is an emergency WHS personnel will escort individuals to the needed area.

## **GYM, TIMELINE, WARM-UP, ETC.**

Please see appropriate map. If you have any questions or need assistance please do not hesitate to ask any of our workers.

Warm-Up and Inspection will be located in our Multipurpose Instructional Facility (MPIF). This is a large field house with an indoor track and 4 basketball courts. Inspection will take place on Court 2. Warm-Up A will be on Court 3 and Warm-Up B will be on Court 4. All areas will be divided by curtains. Transit Areas will be on the Track.

## **HOSPITALITY ROOM**

Located in the Learning Center (Media Center). **Directors, instructors only with IHSCGA Badges please** so you can have a place to get away from the insanity. **Bus drivers, prop truck drivers will have a separate area outside the learning Center in the Main Office Lobby area.**

## **PROPS**

After Check in at Door 5 vehicles will exit the lot to the Left down Hoover Street then take a Left on North Union Street and enter the North Parking Lot to Unload at Door 23. Exit after performance through Door 13 to the east parking lot to load. See map. Prop vehicles will then return to the North lot outside Door 23 where they were parked after unload. A tarp re-fold area is available near the Warm-up area on Court 1.

## **Competition Suite**

All Commentary and Videos will be provided via Competition Suite following your groups performance. WIFI access information will be available in the Directors Hospitality Area.

## **Critique**

Critique will be held for all Classes in the Directors Hospitality Area. Cadet, Divisional Regional A and some of Regional A Round will meet with the 6<sup>th</sup> Judge at the Start of the designated time on the sign up in the small teachers lounge located in the back of the Hospitality Area. Critique for the remaining Regional A Round, A, Open and World Classes will begin in the Hospitality Area at the Conclusion of World Class. **You MUST be signed up for Critique via Competition Suite by Friday February 1<sup>st</sup> in order to attend.**

## **Recaps, sheets, packets**

Will be in hospitality room ASAP.

## **Contact Info**

On the day of the contest please contact via Call or Text Dave Shinault at 317-250-4272 or Emma Derouin at 317-417-4943.

Dave Shinault -  
Cell / Text 317-2504272  
[shinaultd@wws.k12.in.us](mailto:shinaultd@wws.k12.in.us)

# Westfield GUARD SHOW

## BUS AND TRUCK DRIVER INFORMATION

### **Bus Drivers..**

Unload at SE Corner of Westfield HS off N. Union Street Door 5. See provided maps.

Buses will exit the Check IN Area and turn left down Hoover Street then left down Union Street to park in the North Lot of the building outside of Door 23. Drivers will receive their wristband once they have parked from a parking official. **Only one (1) wrist band per bus/equipment vehicle will be distributed.**

**Due to construction Buses will only be allowed to park in this lot or across Hoover Street at Westfield MS.**

For pick up at the conclusion of the contest once your group is ready to leave buses may line up along the sidewalk outside door 4 all the way to door 6. Please inform your drivers to not park outside doors 7&8 as those are for spectators. All equipment vehicles need to stay parked in the North Lot outside door 23 during the contest.

### **Prop Trucks and Drivers**

Will proceed on N. Union street to enter the North Parking Lot to Unload at Door 23. Exit after performance through Door 13 to the east parking lot to load. See map. Prop vehicles will then return to the North lot outside Door 23 where they were parked after unload. Drivers will receive their wristband once they have parked from a parking official. **Only one (1) wrist band per bus/equipment vehicle will be distributed. All other prop personnel will need to check in at Door 5 with the Guard to get their wristbands.**

### **General Info for all drivers**

Everyone (even prop folks) must have an IHSCGA director lanyard or paid wristband for admission to the gym.

The Director / Staff Hospitality room in the Learning Center is for guard directors and TEACHING staff only with IHSCGA lanyards. All others will be asked to leave.

A Driver Hospitality area will be available outside the Learning Center in our

Main office lobby. These are IHSCGA Policies. Thank you.

# Westfield GUARD SHOW

## **FAN / PARENT INFORMATION**

- **DIRECTIONS TO Westfield:** IF YOU ARE USING A GPS DEVICE OR MAPQUEST.....USE 18250 North Union Street, Westfield Indiana, 46074, AS OUR ADDRESS.
- **SPECTATOR PARKING:** Eastside OF THE SCHOOL. THE ACCESS ROAD TO THIS LOT, North Union Street, IS ON THE EAST SIDE OF THE SCHOOL.
- **SPECTATOR ENTRANCE:** South East Side OF THE BUIDING. DOOR 7&8, Cafeteria Entrance.
- **Wristbands:** WE WILL BE USING A WRISTBAND SYSTEM FOR ADMISSION TO THE GYM. Lost wristbands will not be replaced.
- **NO FOOD OR DRINK OR COOLERS MAY BE CARRIED INTO THE BUILDING.**
- **ALL OF THE CAMPUS IS A NON SMOKING FACILITY.**

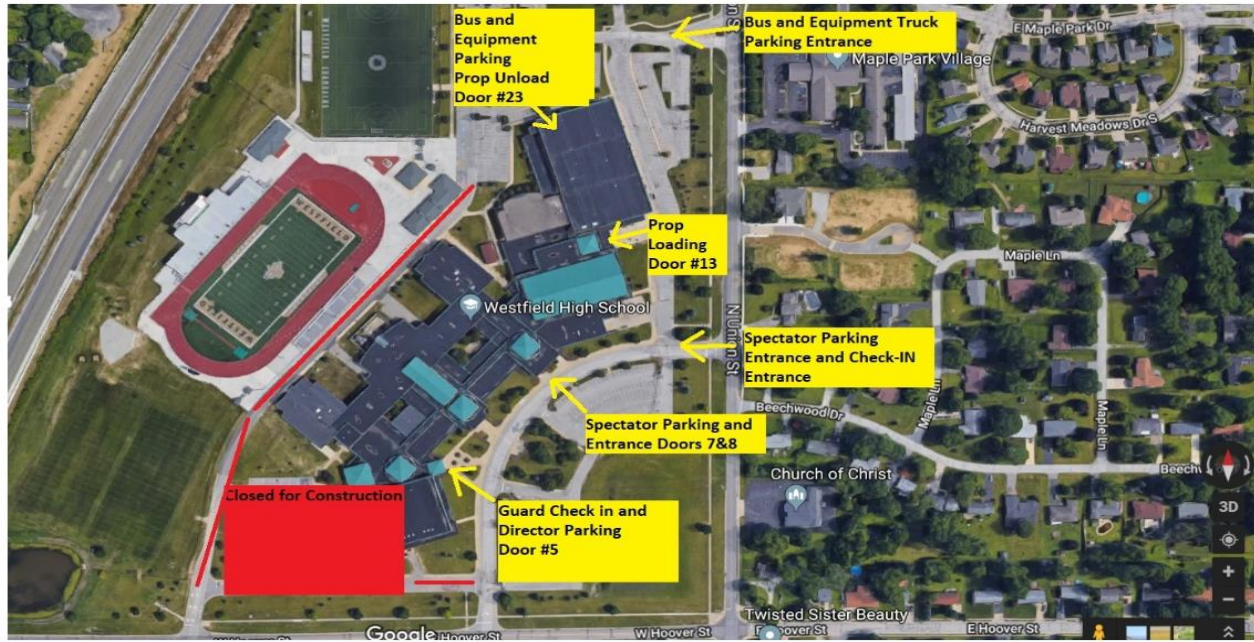



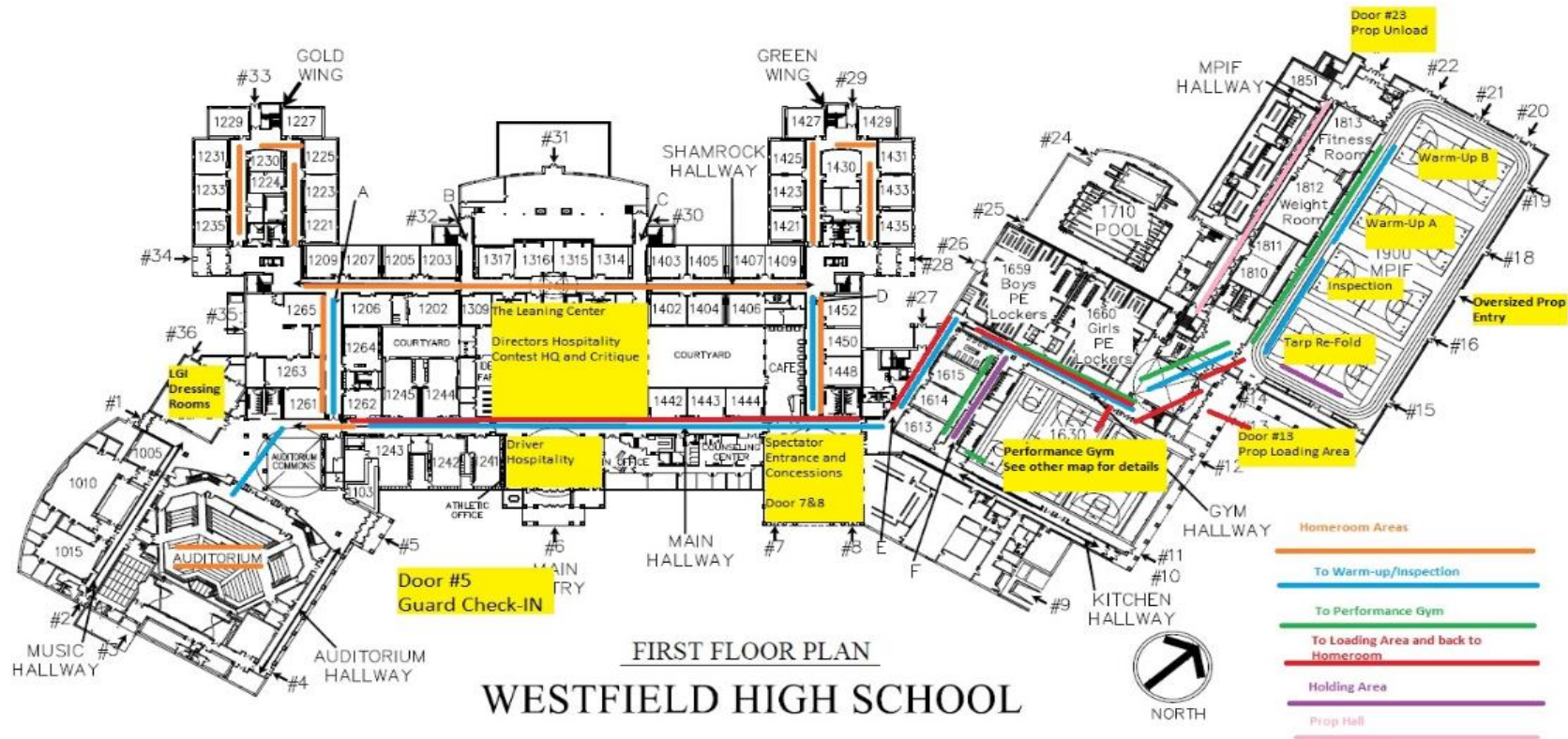

A. Vertical Right to Left

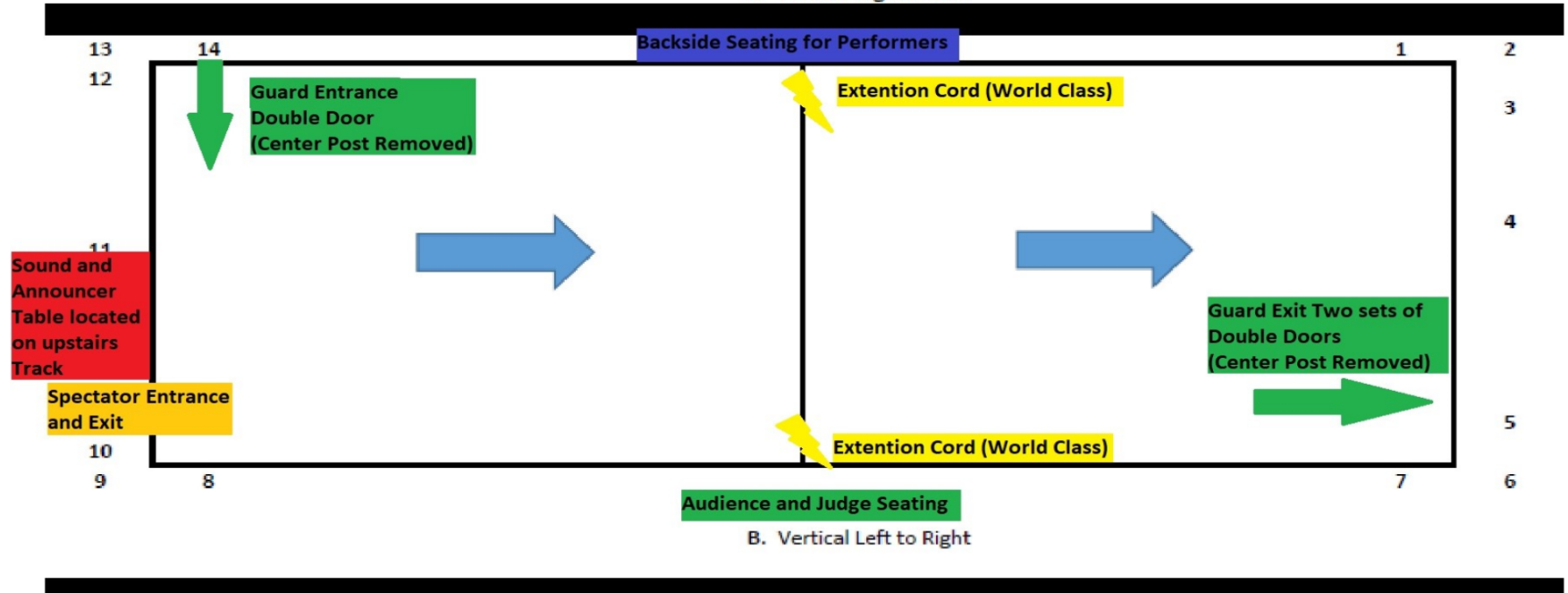

B. Vertical Left to Right