

Northview Winter Guard Show

February 22/23, 2019

OUR MAPQUEST / GPS ADDRESS IS 3150 WEST STATE ROAD 340, BRAZIL, IN

No food or drink may be brought into the building. No coolers will be allowed.

GUARD CHECK IN

Use the Southeast doors, Door 24, in front of school (by the flagpole). Make sure the director of your unit is present to identify the free admissions and check in. Extra student prop tickets are \$3. Extra Adult prop tickets are \$7.

BUS PARKING

Only one choice this year due to construction. At NCMS west of NHS.

ALL violations will result in a penalty per Rule 8.2

Your bus may need to return to the front lot when you vacate your homeroom to pick up equipment, uniforms, etc. Please plan accordingly and have that set up with your driver.

You must vacate your homeroom within one hour after performance.

There will be no bus parking in the front lot until all groups in World Class at the end of the day have arrived and unloaded.

Director Parking

Teacher lot, south of school. See map.

GENERAL SPECTATOR ADMISSION

Tickets may be purchased just inside Door 17, The middle set of doors on the north (back) side of the school. Wristbands will be used. No admission to the gym without a wristband. Tickets will also be on sale at guard check in. Single day admission is \$7. Two-day admission is \$10.

HOMEROOMS

We will provide designated / assigned hallway space and common changing rooms. Some groups will be assigned to the auditorium.

YOU MUST VACATE YOUR HOMEROOM WITHIN ONE HOUR AFTER PERFORMANCE.

GYM, TIMELINE, WARM-UP, ETC.

See the NEW maps!!!! Some things are different this year. We are having a horizontal timeline again.

If you have any questions or need assistance please do not hesitate to ask any of our workers.

HOSPITALITY ROOM

Located in the band room. Directors, instructors only with IHSCGA Badges please so you can have a place to get away from the insanity.

Bus drivers, prop truck drivers will have a hospitality room in the teacher's lounge of the cafeteria. Food will be provided and the bus drivers will receive a food voucher for the concession stand.

PROPS THIS IS DIFFERENT. SEE MAP.

Props will enter through Door 12 on the northwest side of the school. Exit after performance via Door 14 the north parking lot or use the old ag shop overhead door. See map. Prop vehicles will have reserved parking in the north lot close to these doors. Loading dock available close by.

Recaps, sheets, packets

Will be in hospitality rooms asap.

Joshua Miller
School 812 448 2661
Cell / Text 574 312 8615

millerjo@clay.k12.in.us

NORTHVIEW GUARD SHOW BUS AND TRUCK DRIVER INFORMATION

Bus Drivers..

Unload at SE Corner of Northview. See provided maps.

Parking:

At North Clay Middle School. East Side of school.

You might need to be prepared to bring the bus back to the front lot for a moment to pick up uniforms and equipment after they vacate their homeroom.

No parking in the front lot until all World Class groups at the end of the day have arrived and unloaded.

Your hospitality room will be in the teacher's lounge off the cafeteria. There will be food in there for you and we will give you a meal voucher for the concession stand.

Prop Trucks and Drivers

Please enter the lot on the north-most entrance to the north parking lot. Proceed to the west end of the building and circle around to the prop door. After unloading you must move your vehicles to the designated parking area. The far Northwest lot is reserved for prop parking. See map.

After your group's performance props will exit the building in the direction of the NW back lot.

General Info for all drivers

Everyone (even working prop crew) must have an IHSCGA director lanyard or paid wristband for admission to the gym.

You will receive one driver wristband per steering wheel (up to 2 per group) as directed in the IHSCGA manual.

The Director / Staff Hospitality room in the band room is for guard directors and TEACHING staff only with IHSCGA lanyards.

These are IHSCGA Policies. Thank you.

Prop Unloading

Prop Exit

NORTHVIEW HIGH SCHOOL FIRST FLOOR PLAN

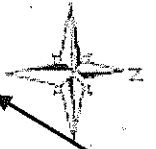

Director Hospitality

WALKWAY
LOBBY

All Warm-Up Areas
New Auxiliary Gym

12

13

14

Audience

Corridor

15

17

Spectator Entrance

HomeRoom

18

19

20

21

22

23

24

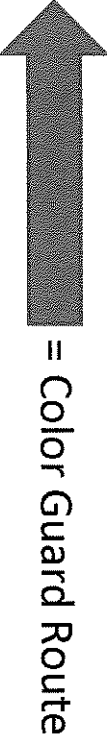

Guard Check-In

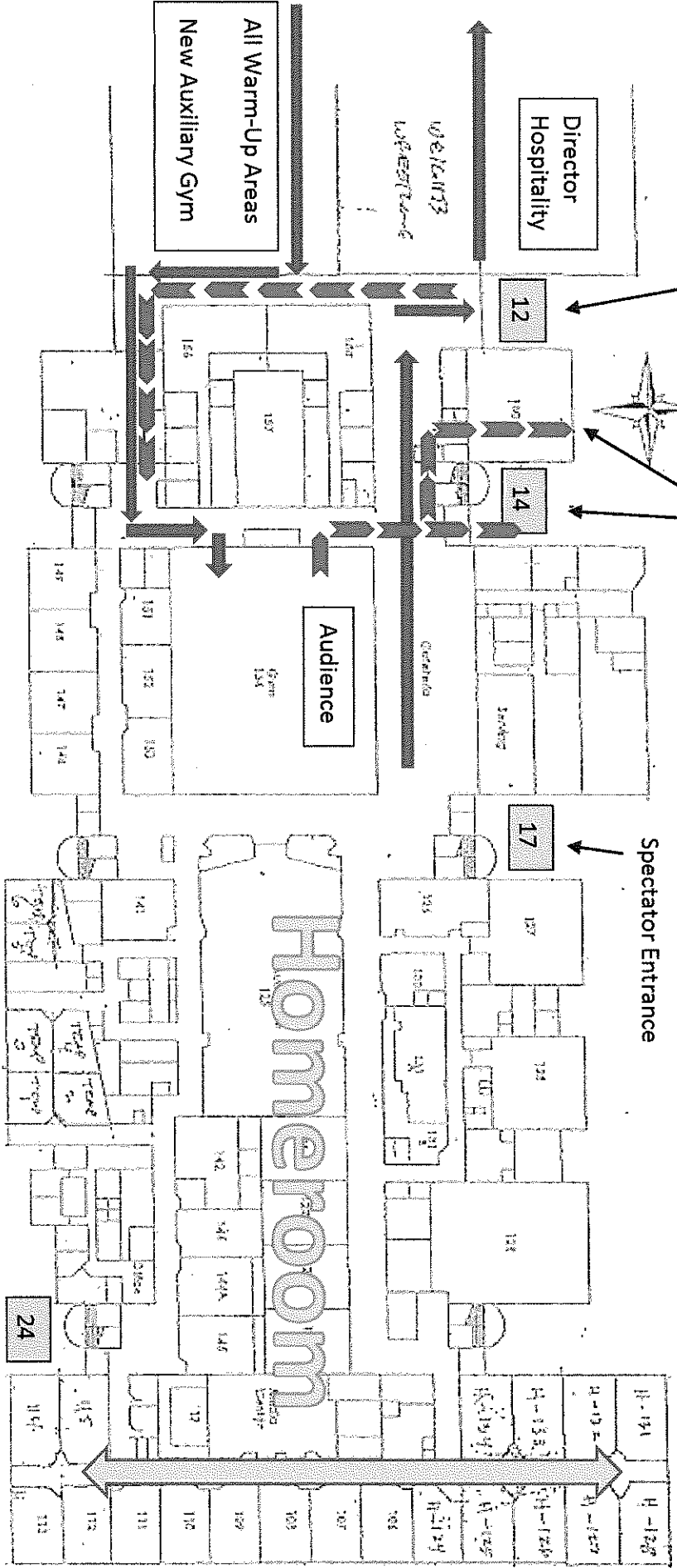

Old Prop Hallway
No Longer used for this event

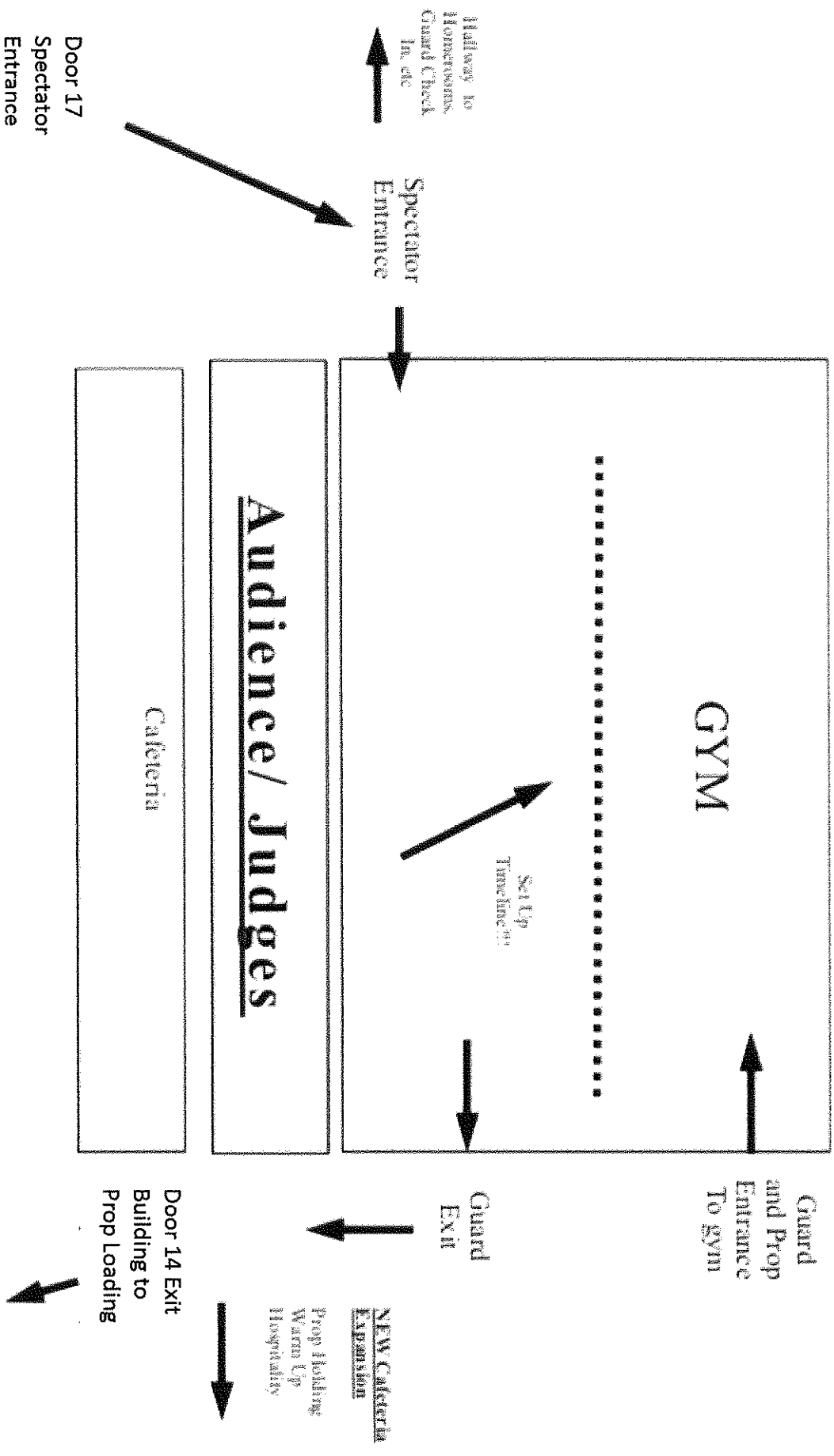

Northview High School Winter Guard Contest

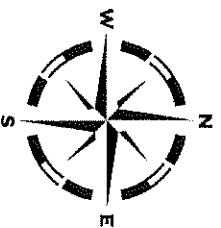

Spectator
Entrance
Door 17

Prop
Vehicle
Parking

Spectator Parking

Prop Vehicles Enter Here

No Bus Parking.
Violation will be an
automatic penalty per
IHSCGA Rule 8.2

Prop
Unloading
Door 12

Prop
Loading
Door 14

Access Road
to NCMS &
ALL
Bus Parking

Director/Staff Parking

Check-In
Door 24
Guard
Member
Entrance
Performer
and Prop
wristband
pick up here

Buses Enter Here from 340

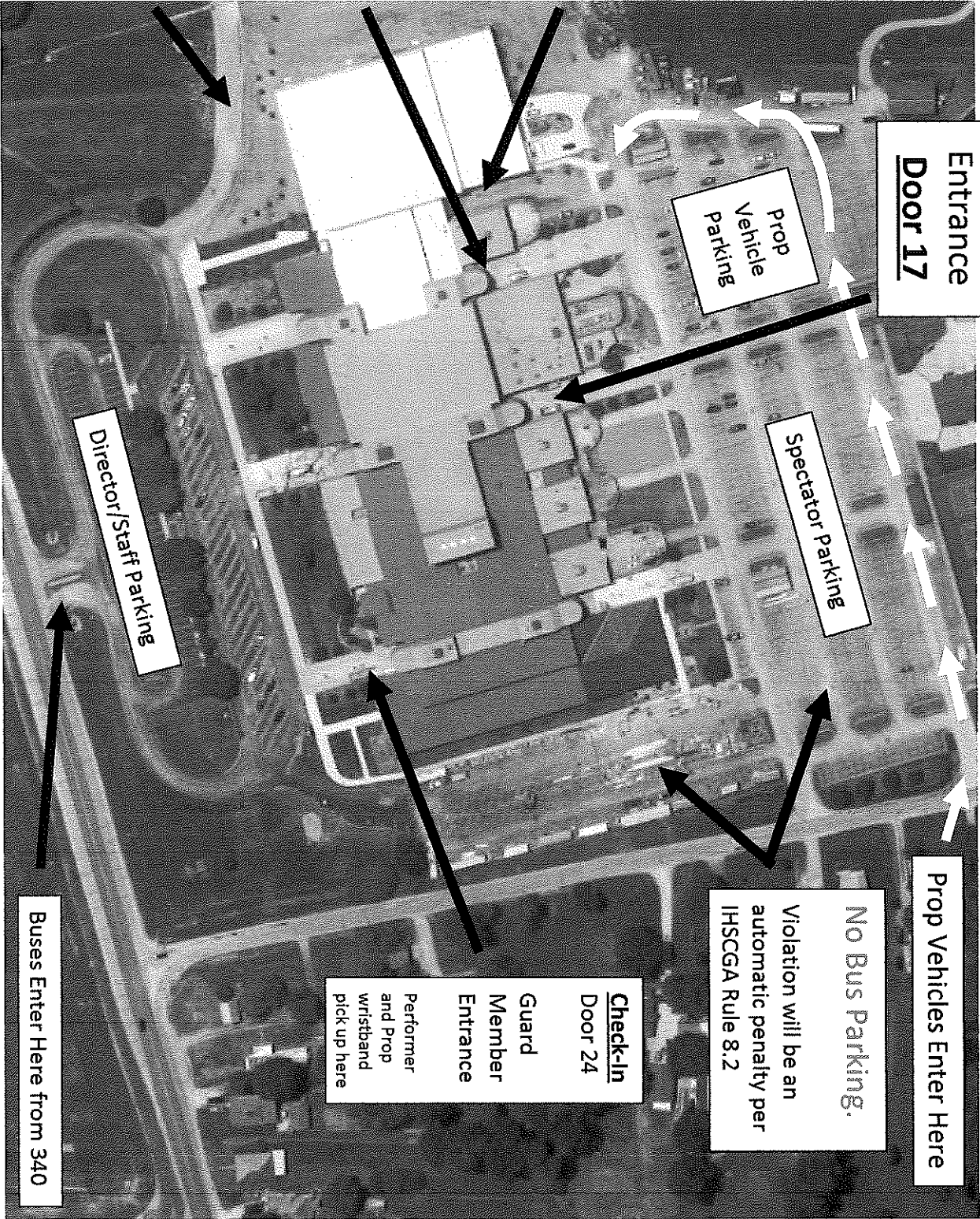

Northview Guard Show *Fan/Parent Information*

- **Directions to Northview:** If you are using a GPS Device or Mapquest, use “3150 W. SR 340, Brazil, Indiana” as our address.
- **Spectator Parking:** North of the school. The access road to this lot is Kennedy Crossing, and is located on the east side of the school.
- **Spectator Entrance:** North side of the building. Door 17. Middle sidewalk.
- **Wristbands:** We will be using a wristband system for admission into the gym. Taped-together wristbands are invalid. Single day admission is \$7. Two-day admission is \$10. Lost wristbands will not be replaced.
*Parents without prop/performer wristbands are not allowed in the homeroom area.
- **No food or drink or coolers may be carried into the building**
- **All of campus is a non-smoking facility.**

