

# **IHSCGA State Prelims**

Saturday March 2<sup>nd</sup>, 2019

IMPORTANT- SHARE WITH YOUR PARENTS, FANS, DRIVERS:  
OUR MAPQUEST/GPS ADDRESS IS **8112 N 200 W, Fortville, IN 46040**

**No food or drink may be brought in to the building. No coolers will be allowed.**

## **GUARD CHECK IN**

Buses and trucks will enter the school off of State Road 234 (south side of the school). Guard Check-In is on the east side of the school just inside Door 7. Make sure the director of your unit is present to collect all necessary wristbands and driver passes. Guards receive performer wristbands for each member on your declaration sheet and eight (8) additional backside wristbands for volunteers (student or adult) Extra backside student tickets are \$3. Front-side wristbands will be for sale as well.

## **BUS PARKING**

Bus parking will be in the lot just north of guard check in. Pending weather, your bus may need to return to Door 7 when you vacate your homeroom to pick up equipment, uniforms, etc. Please plan accordingly and have that setup with your driver ahead of time. There will be no permanent bus parking permitted outside of Door 7.

## **DIRECTOR PARKING**

Director parking will be in the same lot as guard check-in (Door 7). Only directors will be permitted to park here.

## **GENERAL SPECTATOR ADMISSION**

Tickets may be purchased inside Door 17 on the northeast side of the school (enter off 600 W). This is the main gym entrance. Wristbands will be used. No admission to the gym will be permitted without a wristband! Wristbands will also be on sale at guard check-in.

\$10.00 – Adults    \$8.00 – Students K- 12    \$3.00 Children 5 and under    FREE- Infant in Lap

Wristbands are CASH ONLY!

Only paying spectators and directors will be allowed in front-side seating. All performers and free admissions/prop wristbands are back-side seating only.

## **HOMEROOMS**

Homeroom areas will be in school hallways. Please do not leave valuables in the homeroom area. Dressing Rooms will be in the restrooms in the homeroom hallways.

## **IMPORTANT CONCESSIONS INFORMATION**

Due to limited seating on the visitor's side of the gym, we will have a secondary seating/concessions area for performers (see map). This will be located in our cafeteria. We plan on streaming the event to the cafeteria so students can still watch other guards. This secondary concessions area will also accept credit cards.

## **GYM, TIMELINE, WARM-UP, ETC.**

Please see the appropriate, attached map. We will utilize a “vertical, right-to-left” timeline. Sound will be on the same side of the gym as the entrance for performing guards (turn right once in the gym and you will see it). If you have any questions or need assistance, do not hesitate to ask any of our workers!

Warm-Up areas will be in our auxillary gym. We have a 2<sup>nd</sup> floor track running around the gym for an optional, higher vantage point.

Inspection will occur in an isolated hallway along the route from the homeroom area to warm-up.

## **HOSPITALITY ROOM**

Located in the Media Center near the homeroom hallways. **Directors and instructors with an IHSCGA badge only!** Let's have a safe place from the insanity! Drivers will have hospitality in the same location on the opposite side of the staff seating area.

WiFi will be available for INSTRUCTIONAL STAFF ONLY. Login information will be available in hospitality. We may be required to manually enter the information to your device for you. This is to prevent the passwords from leaking to spectators and students.

## **PROPS**

Buses and trucks will enter the school off of State Road 234 (south side of the school). Equipment loading/unloading will take place at Door 11. This is a large garage door leading to our scene shop.

The performance gym's exit has an immediate right turn. Please keep this in mind when moving your props/tarp. You will be able to place your tarp on a cart soon after leaving the gym.

The shortest and narrowest doorways along the prop/tarp route are:

Shortest Doorway Height – 6' 9"  
Narrowest Doorway Width – 4' 10"

The 4'10" wide doorway is the entrance to the gym itself...if this will be an issue please let us know BEFORE the show day so we may plan accordingly. Failure to do so may cause issues with show routing and having to enter the gym from two different doors...across the timeline. We can work around this if we know AHEAD OF TIME!!!

## **RECAPS, SHEETS, VIDEOS**

These will be in the hospitality room at the conclusion of each round. Results will be posted in front of Contest Headquarters. There is NO AWARDS CEREMONY AT THIS EVENT. Videos will be available through your CompetitionSuite Account.

## **PHOTOGRAPHER**

Bateman Photography will be doing group photos, see logistical schedule for times.

## **CONTACT INFORMATION**

### **Director of Bands**

Jackie Nason  
[jackie.nason@mvcsc.k12.in.us](mailto:jackie.nason@mvcsc.k12.in.us)  
219-793-5065 – Cell

### **Performing Arts Secretary**

Christy Stiff  
[Christy.stiff@mvcsc.k12.in.us](mailto:Christy.stiff@mvcsc.k12.in.us)  
765-265-3184 – Cell

### **Event Coordinator**

David Demaree  
[dldemaree1964@gmail.com](mailto:dldemaree1964@gmail.com)  
317-698-1027- Cell

# **State Prelims @ Mt Vernon**

## **BUS AND TRUCK DRIVER INFORMATION**

### **Bus Drivers**

Buses and trucks will enter the school off of State Road 234 (this runs along the south side of the school). Student drop-off will be Door 7. Bus parking will be in the lot just north of guard check in. Pending weather, your bus may need to return to Door 7 when students vacate their homeroom to pick up equipment, uniforms, etc. Please plan accordingly with your guard director. There will be no permanent bus parking permitted outside of Door 7.

Hospitality will be in the Media Center. Please relax from the insanity!

### **Prop Trucks and Drivers**

Enter the south side of the school from State Road 234 (follow your buses). Equipment loading/unloading will take place at Door 11. This is a large garage door to our scene shop. Equipment holding will take place in the hallways adjacent to the scene shop, leading to the performance gym.

Hospitality will be in the Media Center. Please relax from the insanity!

### **General Info for All Drivers**

Everyone (even prop folks) must have an IHSCGA director lanyard or paid wristband for admission to the gym.

The Director/Staff section of the Hospitality area is for guard directors and TEACHING staff only with IHSCGA lanyards. All others will be asked to leave.

These are IHSCGA Policies. Thank you.

# State Prelims @ Mt Vernon

## **FAN/PARENT INFORMATION**

**DIRECTIONS TO NORTHVIEW:** IF YOU ARE USING A GPS DEVICE OR MAPQUEST, USE THE FOLLOWING ADDRESS:

Mt. Vernon High School  
8112 N 200 W  
Fortville IN 46040

**SPECTATOR PARKING:** NORTH OF THE SCHOOL. You will see a band tower and tennis courts next to this lot.

**SPECTATOR ENTRANCE:** NORTH SIDE OF THE BUILDING. Door 17 only!

**TICKET COSTS:** \$10 Adults- \$8 Students K-12 \$3 Children 5 and Under, Infants in lap are FREE  
Principals FREE with IASP Credentials. CASH ONLY!!

**WRISTBANDS:** WE WILL BE USING A WRISTBAND SYSTEM FOR ADMISSION TO THE GYM.  
Lost wristbands will not be replaced!

**NO FOOD, DRINK, OR COOLERS MAY BE CARRIED IN TO THE BUILDING.**

**•THIS CAMPUS IS A NON-SMOKING FACILITY.**

**•CREDIT CARDS ACCEPTED:** We are able to accept credit cards as payment at our concession stands. Admission is cash only.

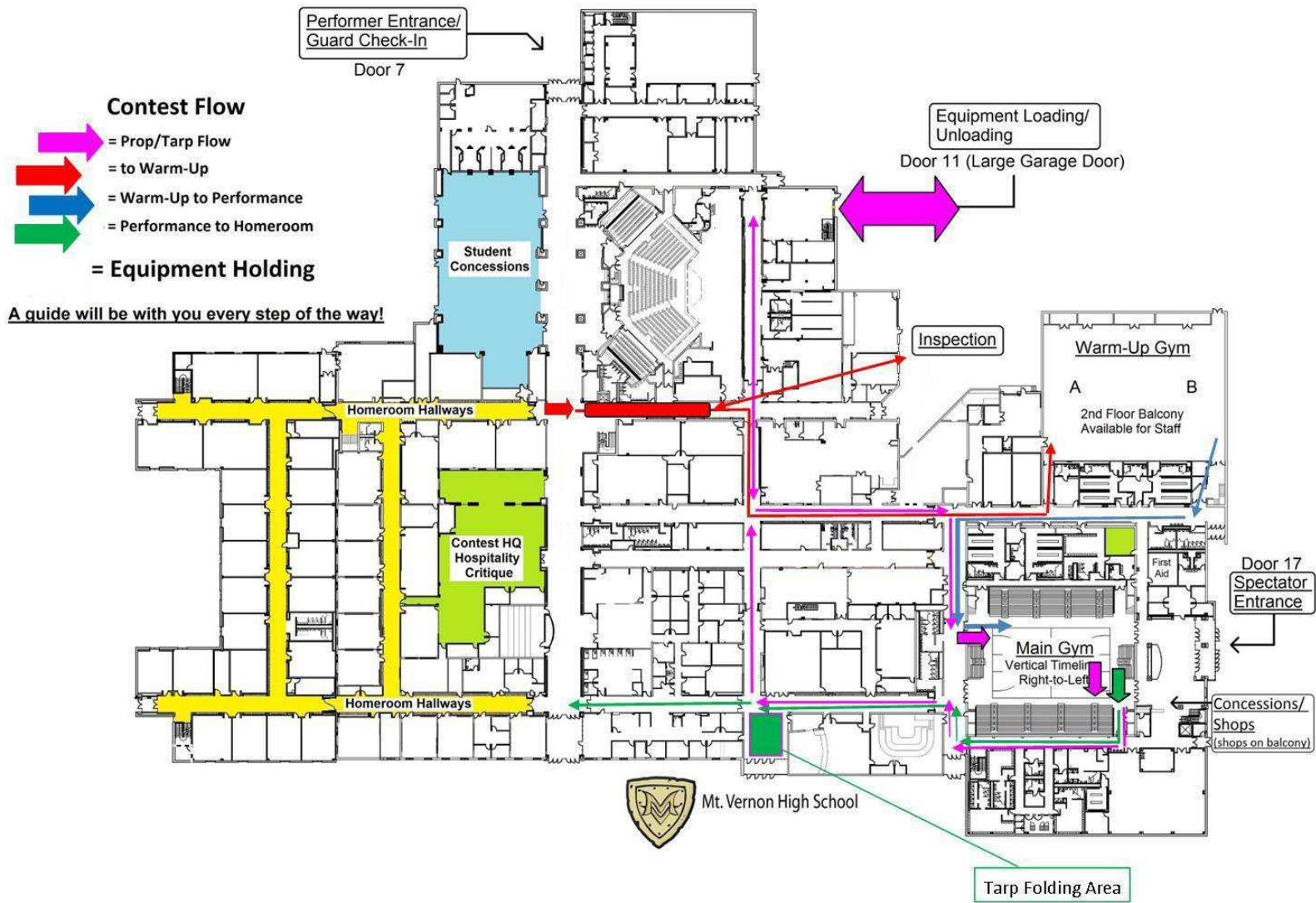

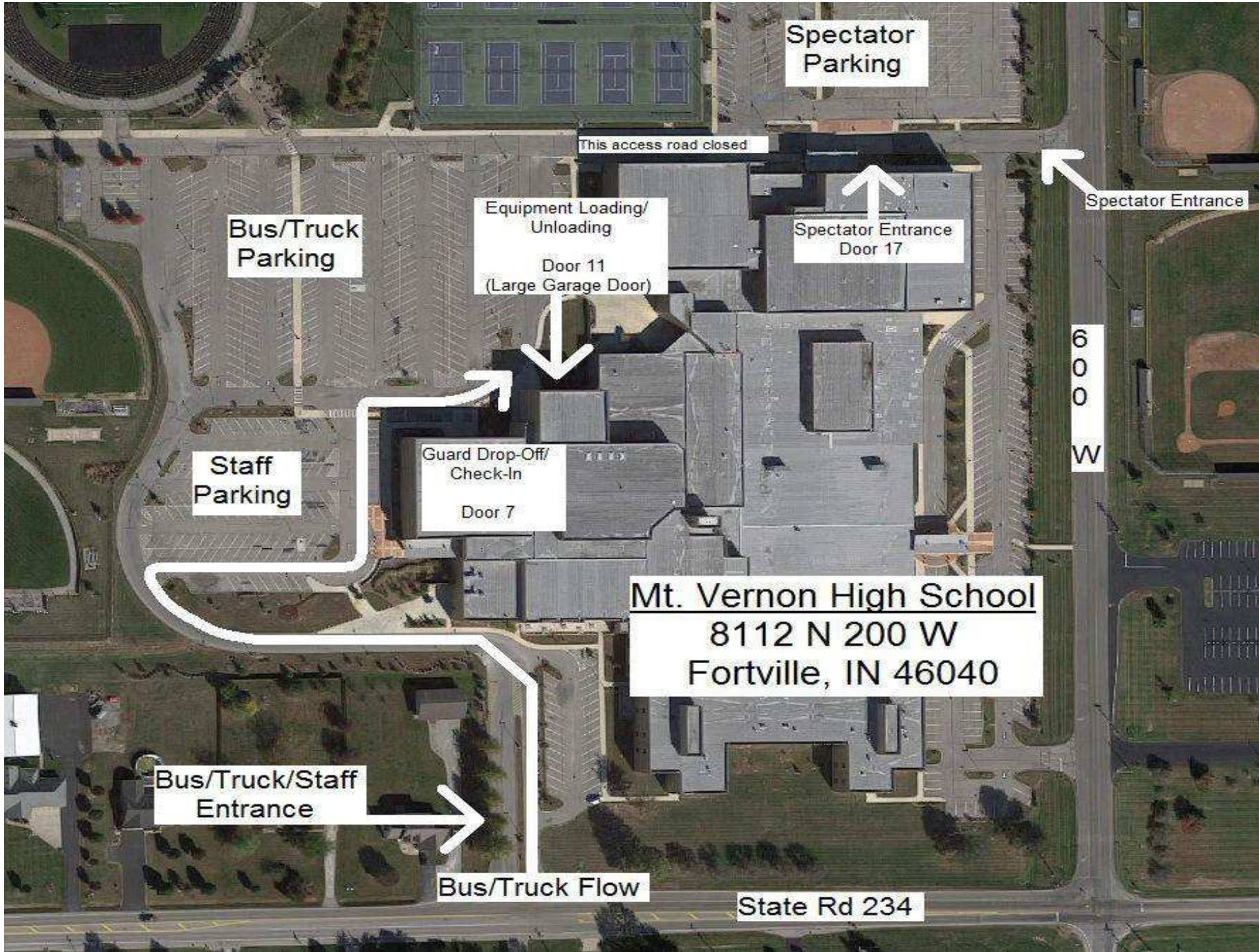

Spectator Parking

This access road closed

Bus/Truck Parking

Equipment Loading/  
Unloading  
Door 11  
(Large Garage Door)

Spectator Entrance  
Door 17

Spectator Entrance

Staff Parking

Guard Drop-Off/  
Check-In  
Door 7

600  
W

Mt. Vernon High School  
8112 N 200 W  
Fortville, IN 46040

Bus/Truck/Staff  
Entrance

Bus/Truck Flow

State Rd 234

GUARD EXIT

BACKSIDE

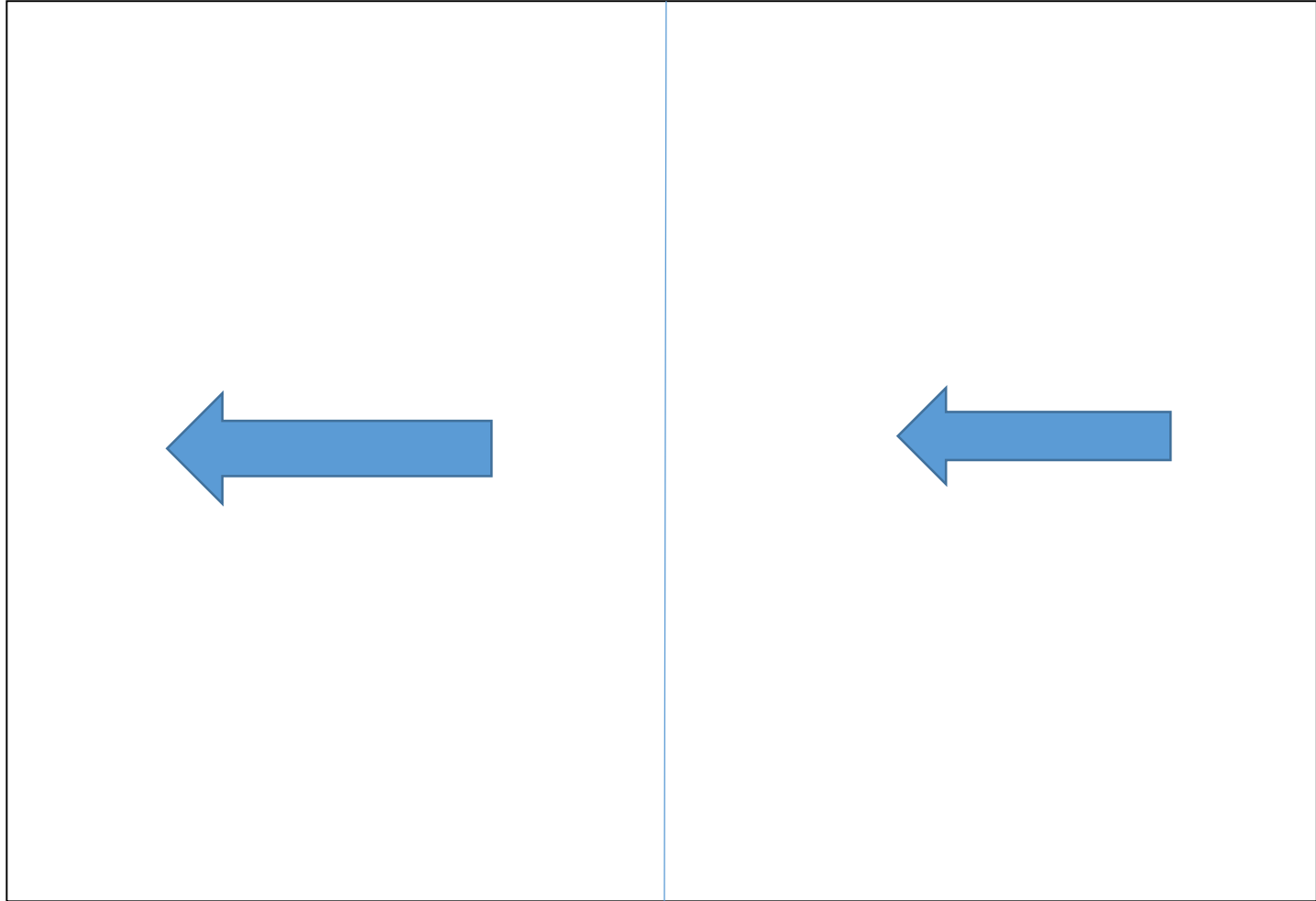

GUARD ENTER

Spectators/Judges