

IHSCGA State Prelims

Saturday, March 8, 2025

Franklin Central High School
6215 S Franklin Rd
Indianapolis, IN 46259



***Franklin Central's show flow is different from past years.
Please review this packet and the attached maps!***

***Food or drink may NOT be carried into or delivered to
the building!***

UNIT CHECK-IN

Buses will enter off of Indian Creek Road on the south side of the high school. Unit Check-In will take place at Door 1W, the main entrance of the building. Please refer to the signs and attached maps for specific parking areas and traffic flow.

BUS / TRUCK / STAFF PARKING

Buses, Equipment Vehicles, and Staff Vehicles will enter off of Indian Creek Road on the south side of the high school. We will have booster parent volunteers directing parking. Please refer to the signs and attached maps for specific parking areas and traffic flow.

Groups cannot arrive earlier than one hour prior to their "Transit to Photos" time.

***Each group's trucks/trailers must depart the campus by 60 minutes after their performance.
Buses can remain on campus throughout the day.***

***If your group is staying on campus longer than 60 minutes past your performance time, your
trucks/trailers can be parked across the street at Kitley Intermediate.
(8735 Indian Creek Rd, Indianapolis, IN 46259)***

SPECTATOR PARKING

Spectator parking will be along the north and west sides of the building. Enter off Franklin Road, near the football stadium. We will have booster parent volunteers directing parking. Please refer to the signs and attached maps for specific parking areas and traffic flow.

Additional spectator parking is available across the street at 'The Creek' church.

SPECTATOR ADMISSION

Spectators will enter and exit the building via the "PERFORMANCE ENTRANCE", door 8W, on the west side of the building. See attached map for details.

Cash and card will be accepted at ticket sales and concessions.

<u>Ticket</u>	<u>Cash</u>	<u>Online or Card</u>
Adults	\$10	\$10 + Card Fees
Children 5 and Under	\$3	\$3 + Card Fees
Infant in Lap	Free	Free

IHSCGA State Events will be taking place at two sites this weekend.

Purchasing a ticket at one site will grant access to both sites.

You must keep your wristband to access both sites.

EQUIPMENT ENTRANCE

Equipment will ENTER the building at Door 34S on the south side of the building and follow a predetermined route to the performance gym.

EQUIPMENT EXIT

Equipment will EXIT the building at Door 36S on the south side of the building.

PROP / TARP FLOW - Door Heights/Widths

See below for the shortest and narrowest points along the equipment and tarp route. The route's narrowest/shortest point is a standard set of double-doors. Contact us if you have any questions or concerns. See attached map for details.

	<u>Door Frame</u>	<u>at Push-Bar</u>
Shortest Height along Route:	6' 11" (83")	n/a
Narrowest Width along Route:	5' 10" (70")	5' 6" (66")
<i>Narrowest Width if Using Tarp Folding:</i>	<i>5' 1" (61")</i>	<i>4' 6" (54")</i>

PERFORMANCE GYM ENTRANCE & EXIT

Performers/props/tarps will enter the performance gym from the back left corner (from the audience's vantage point). Performers/props/tarps will exit the performance gym from the front right corner (from the audience's vantage point).

PERFORMANCE GYM TIMELINE

The performance gym utilizes a **VERTICAL TIMELINE**.

WARM-UP

The warm-up space is a full gym split into an “A” and “B” warmup. A portable speaker with Bluetooth and USB-C connections will be available for use. Please have a backup sound source in the event of connection or technical issues with this speaker. See attached map for details.

HOMEROOMS

Groups will use the Main Cafeteria as a homeroom space. Please do not leave any important items unsupervised. IHSCGA and Franklin Township are not responsible for lost or stolen items. See attached map for details.

STAFF HOSPITALITY

Staff hospitality is located in the Guidance Office. This is next to Unit Check-In. Access to director/staff hospitality is only permitted with an IHSCGA Director Badge. All others will be asked to leave. See attached map for details.

DRIVER HOSPITALITY

Driver hospitality is located in room 816/821. This is in the performance gym lobby. See attached map for details.

FIRST AID

First Aid is located in the performance gym, next to the unit exit doors. See attached map for details.

RECAPS / CRITIQUE

Recaps will be available via Competition Suite.

Critique will not be available at this event.

AWARDS

This event will not feature an award ceremony.

CONTEST HEADQUARTERS

Contest Headquarters is located in the Auditorium Lobby. This is next to the spectator ticketing area. See attached map for details. Please use the contact information below if you need to speak with a building representative.

CONTACT INFORMATION

Missi Magness
Contest Coordinator
events@fcbands.org
317-797-8370

Derek Ellinger
Director of Bands
derek.ellinger@ftcsc.org
317-496-7714

Jaclyn Nason
Associate Director of Bands
jaclyn.nason@ftcsc.org
219-793-5065

IHSCGA STATE PRELIMS

FRANKLIN CENTRAL HIGH SCHOOL

BUS / EQUIPMENT DRIVER INFORMATION

Address

Franklin Central High School
6215 S Franklin Rd
Indianapolis, IN 46259

Bus and Equipment Vehicle Drivers

Buses and Equipment Vehicles will **enter off of Indian Creek Road** on the south side of the high school. We will have booster parent volunteers directing parking. Please refer to the signs and included maps for specific parking areas and traffic flow.

CAMPUS ENTRY	INDIAN CREEK RD (<i>south of bldg</i>)
UNIT CHECK-IN	Door 1W
EQUIPMENT ENTRANCE	Door 34S
EQUIPMENT EXIT	Door 36S

Groups cannot arrive earlier than one hour prior to their "Transit to Photos" time.

***Each group's trucks/trailers must depart the campus by 60 minutes after their performance.
Buses can remain on campus throughout the day.***

***If your group is staying on campus longer than 60 minutes past your performance time, your trucks/trailers can be parked across the street at Kitley Intermediate.
(8735 Indian Creek Rd, Indianapolis, IN 46259)***

Driver hospitality is located in room 816/821. This is in the performance gym lobby.

Performance Gym Admission

Every non-performing guest, including prop helpers, must have an IHSCGA Director Badge or wristband to enter the performance gym.

IHSCGA STATE PRELIMS

FRANKLIN CENTRAL HIGH SCHOOL

SPECTATOR INFORMATION

Address

Franklin Central High School
6215 S Franklin Rd
Indianapolis, IN 46259

Spectator Parking

Spectator parking will be along the north and west sides of the building. Enter off Franklin Road, near the football stadium. Overflow parking is available across Franklin Road at 'The Creek' church.

Spectator Entrance

Door 8W, the "PERFORMANCE ENTRANCE"

Admissions Information

Cash and card will be accepted at ticket sales and concessions.

Food or drink may NOT be carried into or delivered to the building!

<u>Ticket</u>	<u>Cash</u>	<u>Online or Card</u>
Adults	\$10	\$10 + Card Fees
Children 5 and Under	\$3	\$3 + Card Fees
Infant in Lap	Free	Free

***IHSCGA State Events will be taking place at two sites this weekend.
Purchasing a ticket at one site will grant access to both sites.
You must keep your wristband to access both sites.***

PERFORMANCE GYM LAYOUT

Backside Seating

Unit
Entrance

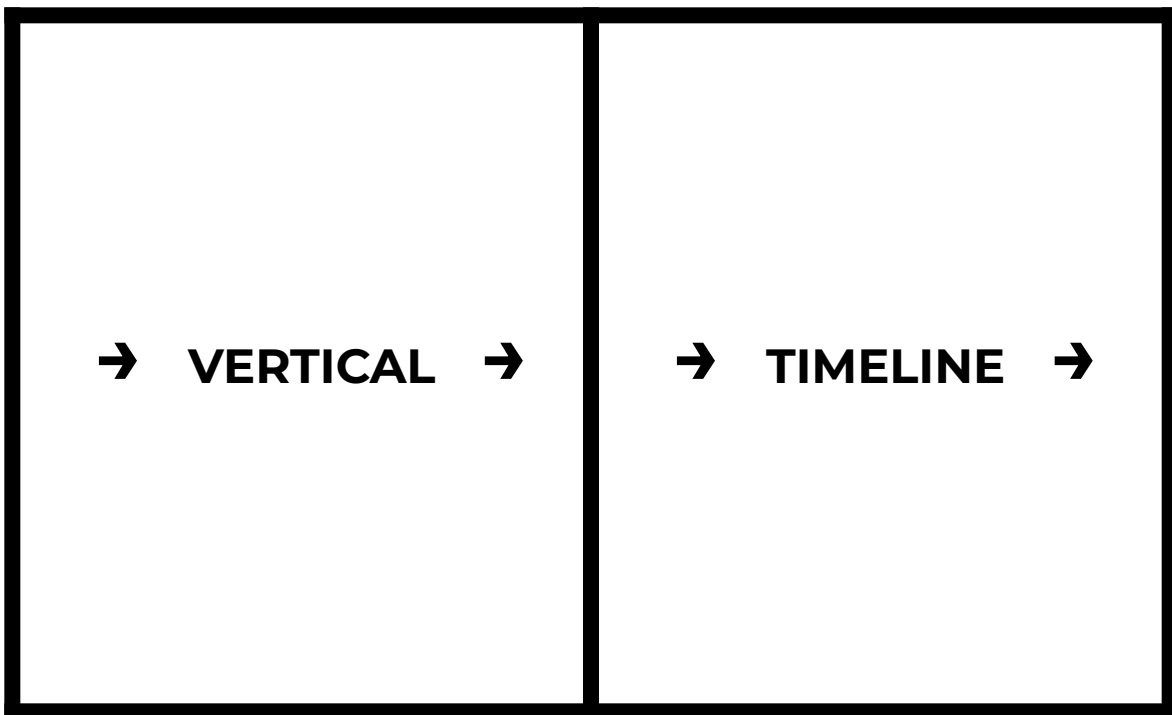

Unit Exit

Spectator Seating

GUARD STATE PRELIMS

FRANKLIN CENTRAL HIGH SCHOOL

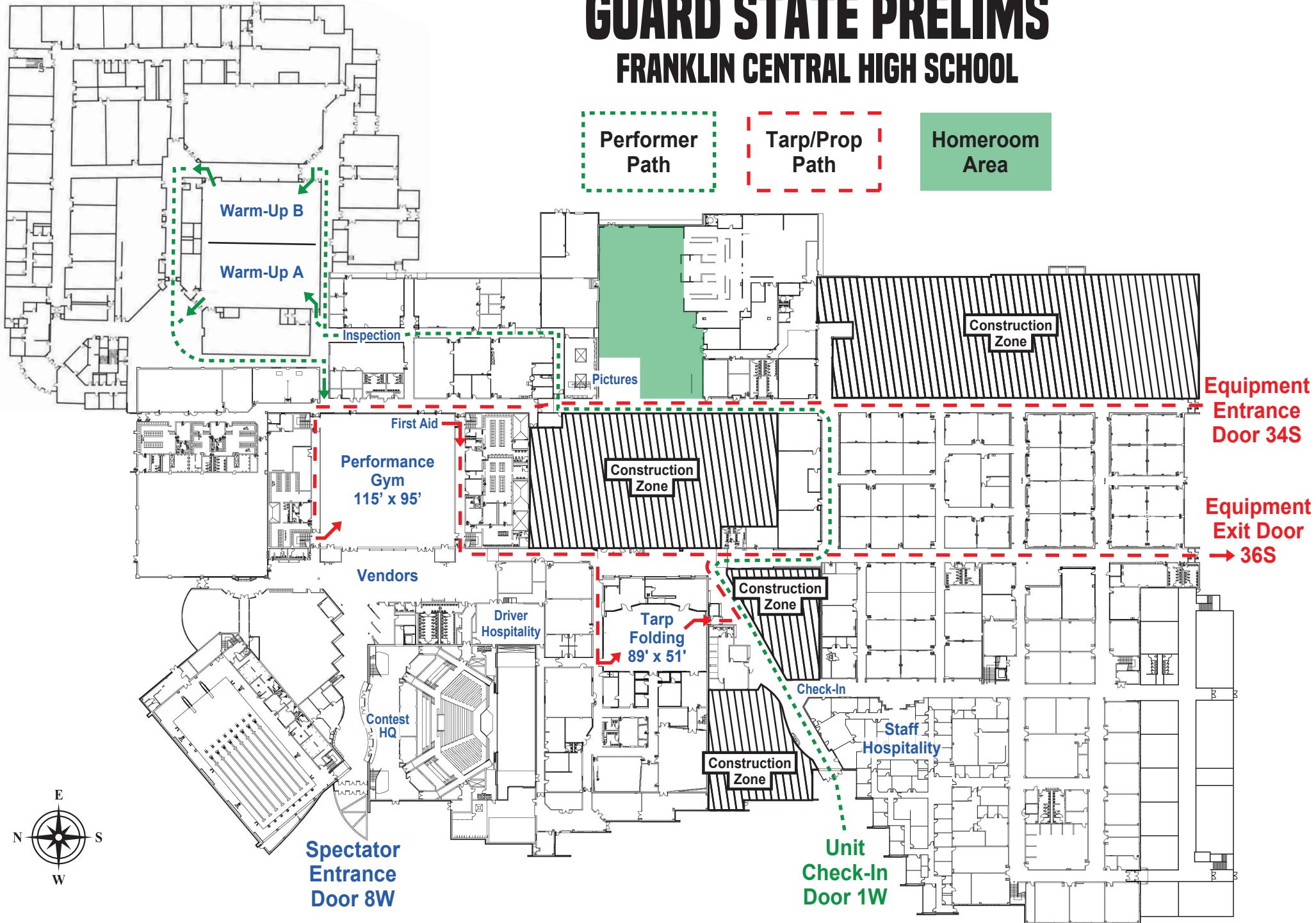

GUARD STATE PRELIMS

FRANKLIN CENTRAL HIGH SCHOOL
6215 S FRANKLIN RD, INDIANAPOLIS, IN 46259

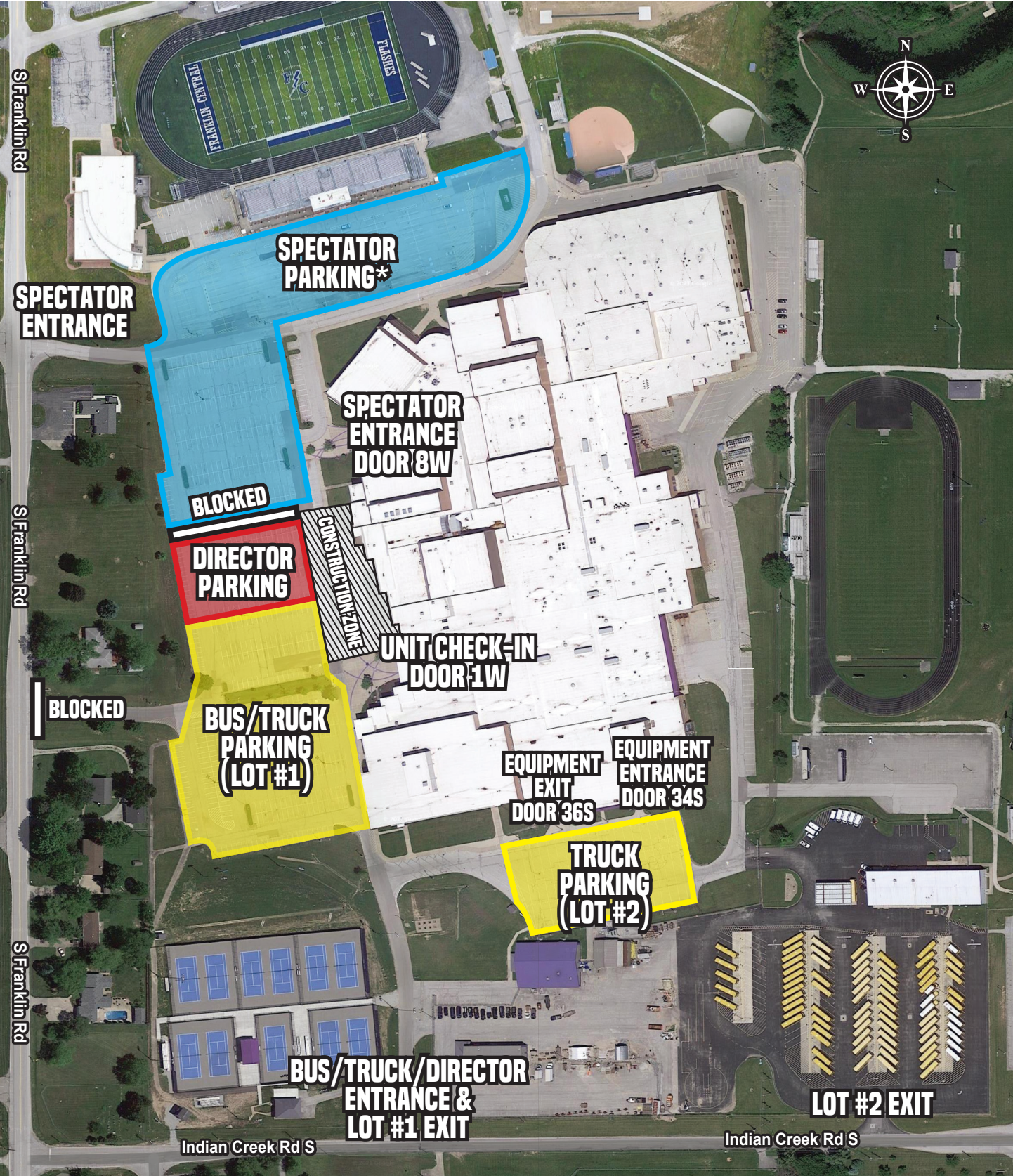

*OVERFLOW SPECTATOR PARKING IS AVAILABLE ACROSS FRANKLIN RD AT 'THE CREEK' CHURCH.